



BIMEX
 5 Am Duerf
 L - 9637 Bockholtz
 Grand Duchy of Luxemburg

Tel.: +352 899 477
 Fax.: +352 899 478
 email : bimexlux@pt.lu

07.600

PENSTOCK VALVES
VANNES MURALES

Non rising stem - Tige non montante

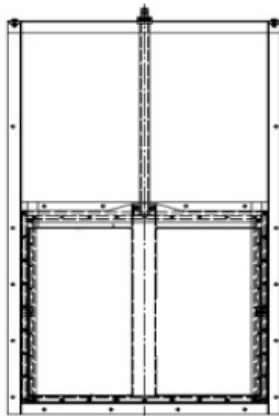

Rising stem - Tige montante

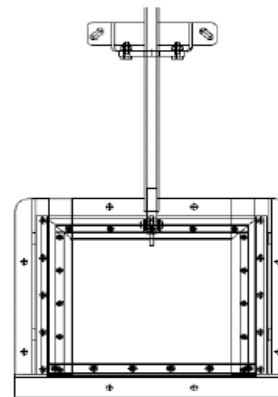

| DESCRIPTION | MATERIAL |
|---------------------|------------------------------|
| FRAME | STAINLESS STEEL AISI 304 (1) |
| GATE | STAINLESS STEEL AISI 304 (1) |
| EXTENSION AND GUIDE | STAINLESS STEEL AISI 304 (1) |
| HEADSTOCK | STAINLESS STEEL AISI 304 (1) |
| SPINDLE | STAINLESS STEEL AISI 303 (1) |

| DESCRIPTION | MATERIAU |
|------------------|-------------------------|
| CADRE | ACIER INOX AISI 304 (1) |
| OBTURATEUR | ACIER INOX AISI 304 (1) |
| ALLONGE ET GUIDE | ACIER INOX AISI 304 (1) |
| COLONETTE | ACIER INOX AISI 304 (1) |
| TIGE ALLONGE | ACIER INOX AISI 303 (1) |

| NORMES / NORMS |
|----------------|
| EN 10088-1 |
| EN 10088-1 |
| EN 10088-1 |
| EN 10088-1 |
| EN 10088-1 |

Applications : water treatment and purification, pumpings, irrigation, collectors, etc.

Watertightness : according to ANSI/AWWA C561-04 standard.

Applications : traitement et purification d'eau, pompages, irrigation, collecteurs, etc.

Etanchéité : suivant norme ANSI/AWWA C561-04.

Accessories / Accessoires :

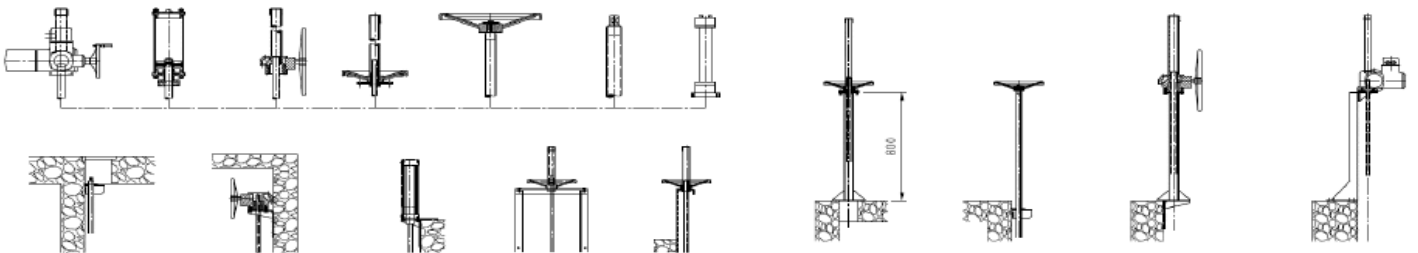

(1) Alternately : AISI 316

(1) Alternativement : AISI 316

Non rising stem - Tige non montante

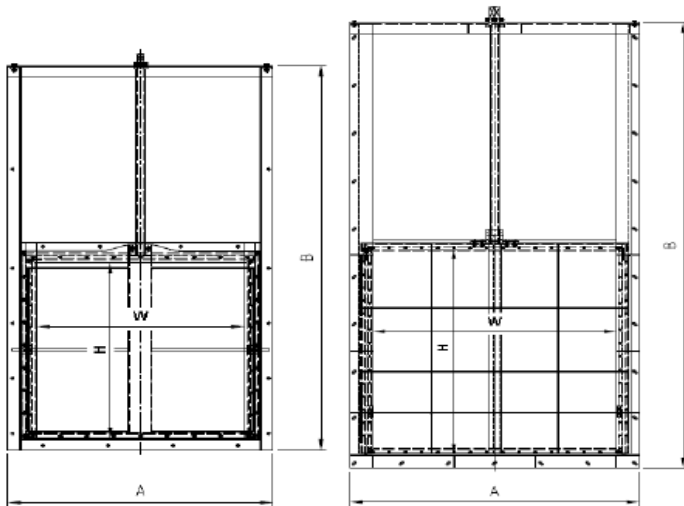

Rising stem - Tige montante

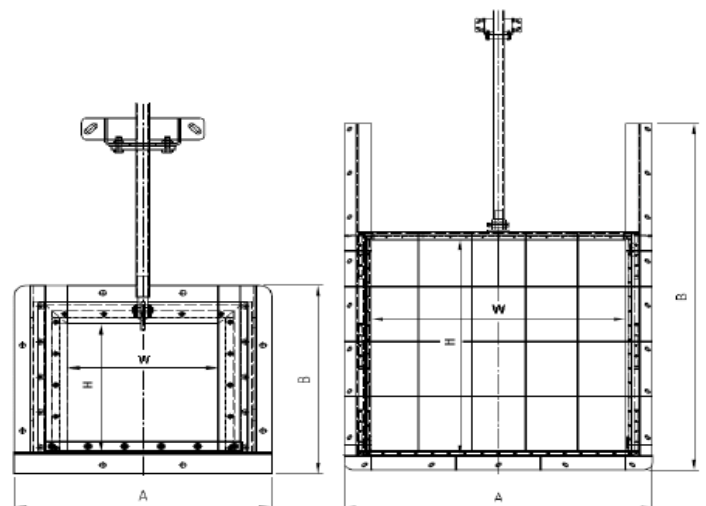

Non rising stem - Tige non montante

| <i>W x H</i> | <i>A</i> | <i>B</i> |
|--------------|-----------|-----------|
| <i>mm</i> | <i>mm</i> | <i>mm</i> |
| 200 x 200 | 380 | 545 |
| 300 x 300 | 480 | 745 |
| 400 x 400 | 580 | 945 |
| 500 x 500 | 680 | 1145 |
| 600 x 600 | 780 | 1345 |
| 700 x 700 | 880 | 1545 |
| 800 x 800 | 980 | 1745 |
| 900 x 900 | 1130 | 2016 |
| 1000 x 1000 | 1230 | 2216 |
| 1100 x 1100 | 1330 | 2416 |
| 1200 x 1200 | 1430 | 2616 |
| 1300 x 1300 | 1650 | 2916 |
| 1400 x 1400 | 1750 | 3116 |
| 1500 x 1500 | 1950 | 3316 |
| 1600 x 1600 | 1950 | 3530 |
| 1700 x 1700 | 2050 | 3730 |
| 1800 x 1800 | 2150 | 3980 |
| 1900 x 1900 | 2250 | 4180 |
| 2000 x 2000 | 2350 | 4458 |

Other dimensions on request

Rising stem - Tige montante

| <i>W x H</i> | <i>A</i> | <i>B</i> |
|--------------|-----------|-----------|
| <i>mm</i> | <i>mm</i> | <i>mm</i> |
| 200 x 200 | 380 | 330 |
| 300 x 300 | 480 | 430 |
| 400 x 400 | 580 | 530 |
| 500 x 500 | 680 | 630 |
| 600 x 600 | 780 | 730 |
| 700 x 700 | 880 | 830 |
| 800 x 800 | 980 | 930 |
| 900 x 900 | 1130 | 1420 |
| 1000 x 1000 | 1230 | 1570 |
| 1100 x 1100 | 1330 | 1720 |
| 1200 x 1200 | 1430 | 1870 |
| 1300 x 1300 | 1650 | 2020 |
| 1400 x 1400 | 1750 | 2170 |
| 1500 x 1500 | 1950 | 2320 |
| 1600 x 1600 | 1950 | 2470 |
| 1700 x 1700 | 2050 | 2620 |
| 1800 x 1800 | 2150 | 2770 |
| 1900 x 1900 | 2250 | 2920 |
| 2000 x 2000 | 2350 | 3070 |

Autres dimensions sur demande.